

WIR-TRAN

Rated for use on 110/120VAC 60Hz applications

Installation Instructions: Read these instructions in its entirety before performing any installation work.

FOR USE WITH POOL AND SPA PRODUCTS

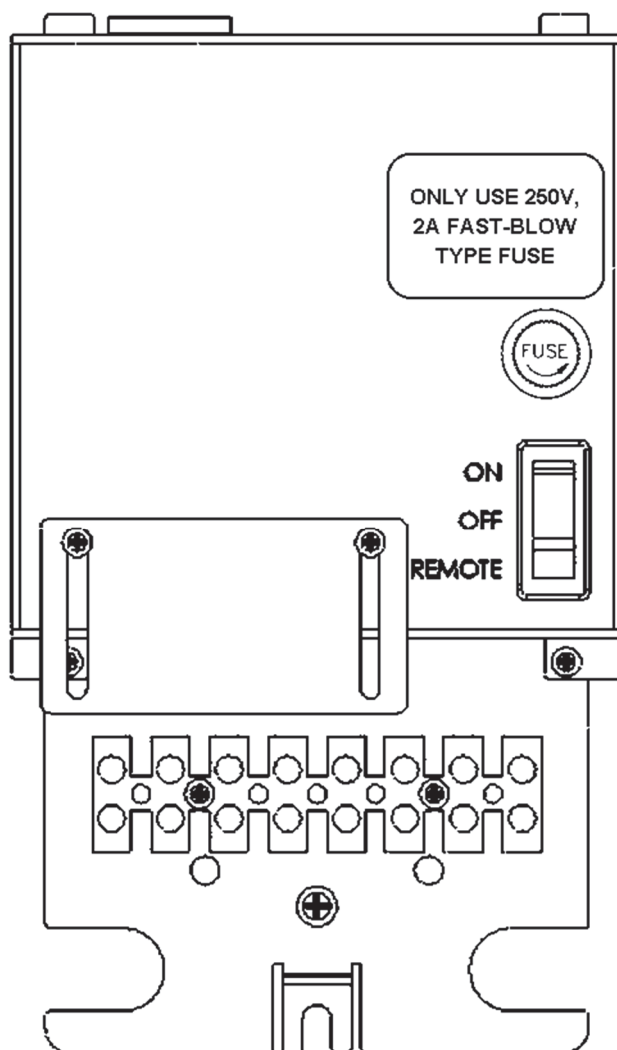

ETL LISTED
Conforms to UL STD 379;
Certified to CSA STD C22.2 #218.1



Intertek
4008814

The WIR-TRAN consists of the following parts:

Item #	Qty.	Component Part #	Description
1	1	A10670	Screw, 8-32, 1/4" length
2	1	02-15285-00	Relay Cover
3	1	02-15314-00	Bracket Mount, WIR-TRAN
4	2	10-15031-03	Screw, 6-32, 1/4" length
5	2	10-15089-07	M3 Screw, 14mm length
6	6	10-15089-01	M3 Screw, 4mm length
7	2	11-15005-00	Nut, 6-32, Star Lock
8	4	14-15032-00	PCB Standoff
9	1	72-15210-00	Bracket, Mounting Plate
10	1	38-15012-00	Rocker Switch, 20A, 125VAC
11	1	41-15004-08	8 Position Terminal Block
12	1	LS-12V	Transformer, 12VAC
13	1	94-15257-00	Antennae, Repeater, 915MHz
14	1	94-15256-00	Receiver, 1-ckt, 915MHz
15	1	A12664	Fuse Holder, 250V, 10A max
16	1	94-15254-00	Transmitter, 1-ckt, 915MHz (not shown)
17	2	41-15005-00	Push-Wire Connector, 6-Conductor, (not shown)
18	1	36-15015-00	Fuse, 250V, 2.0A, 1-1/4"x1/4", Fast-Blow (not shown)

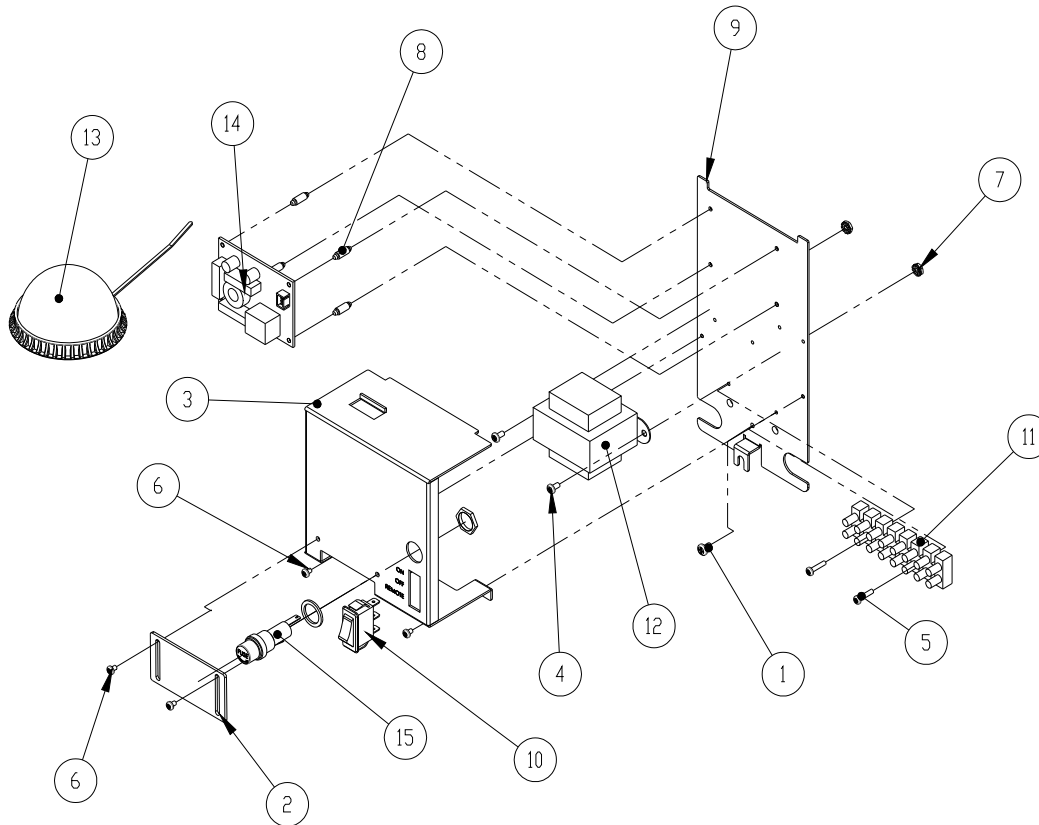

Accessory Item: WE-65 65 ft. Repeater Cord Extension Kit



SAVE THESE INSTRUCTIONS!



DANGER – FAILURE TO FOLLOW THESE WARNINGS, INSTRUCTIONS AND THE OWNER'S MANUAL MAY RESULT IN SERIOUS INJURY OR DEATH

IMPORTANT SAFETY INFORMATION

Basic safety precautions should be observed when operating the WIR-TRAN product and other associated equipment.

1. A qualified electrician must install the WIR-TRAN in accordance to the National and Local Electrical Codes.
2. The WIR-TRAN must not be less than 5 feet (3 meters in Canada) from inside edge of pool. **ONLY USE COPPER CONDUCTORS.**
3. Do not exceed the maximum ratings of individual components, wiring devices, and current carrying capacity of conductors.
4. For the bonding, grounding, installing, and wiring of underwater lights to the WIR-TRAN refer to Article 680 of the National Electrical Code or Article 68 of the Canadian Electrical Code.
5. This device should never operate equipment that could cause property damage, bodily injury, or death should it be activated unexpectedly.
6. Never allow children to operate the WIR-TRAN unsupervised.

FCC WARNING

1. This device complies with Part 15 of the FCC Rules. Operation is subject to the following two conditions: (1) this device may not cause harmful interference, and (2) this device must accept any interference received, including interference that may cause undesired operation.
2. Changes or modifications not expressly approved by S.R. Smith could void the user's authority to operate the equipment.

ELECTRICAL RATINGS

Do not exceed the maximum electrical output rating of 30W for the WIR-TRAN. Install a 20Amp, 120VAC GFCI Circuit Breaker for power input. Refer to pages 4 and 5 for installation instructions.

FUSE REPLACEMENT

To help protect internal parts, the WIR-Tran is equipped with a fuse. In the event that the fuse needs replacement, only use a 250V, 2A Fast-Blow (fast acting) type similar to what is equipped from the factory. You may also order SR Smith part number 36-15015-00 from your local authorized distributor.

WARNING

- TURN OFF INCOMING POWER BEFORE SERVICING EQUIPMENT.
- ALL INSTALLATION AND MAINTENANCE WORK MUST BE PERFORMED BY QUALIFIED ELECTRICAL PERSONEL ONLY.
- GFCI BREAKER MUST BE USED TO CONNECT WIR-TRAN TO INPUT POWER.
- VERIFY ALL ELECTRICAL RATINGS BEFORE INSTALLATION IS COMPLETE.

LOCATION

The WIR-TRAN is housed in a Type 3R rainproof enclosure and can be mounted anywhere between the pool equipment and the breaker panel.

WIRING INSTRUCTIONS

FOLLOW PROPER WIRING PRACTICES IN ACCORDANCE WITH ALL LOCAL REGULATORY REQUIREMENTS.

Power Connections:

To wire the WIR-TRAN use insulated COPPER wire only, 12 gauge minimum. Run a 1/2" to 3/4" conduit from the main breaker panel to the right most bottom conduit knock out of the WIR-TRAN. Pull appropriate wires from the main breaker panel to the WIR-TRAN unit. To make the input power connections, unscrew the Isolation Cover covering the right side of the terminal strip and remove 3/8 inches of insulation from the wire ends. Insert the bare end of wires under the pressure plate of terminals (Power Input 120V AC, NEUTRAL). Use 1/8-in. flat head screwdriver to tighten terminal screws firmly (10.0 in-lbs. minimum). Connect the house ground line to the Input Ground line on the WIR-TRAN. Install a 20 Amp max GFCI circuit breaker in the main breaker panel and connect the **HOT** wires from the WIR-TRAN. As a final step replace the Isolation Cover over the Input wire terminals and reattach the grounding attachment screw. Use provided cable tie to secure the Input Wires to the cover.

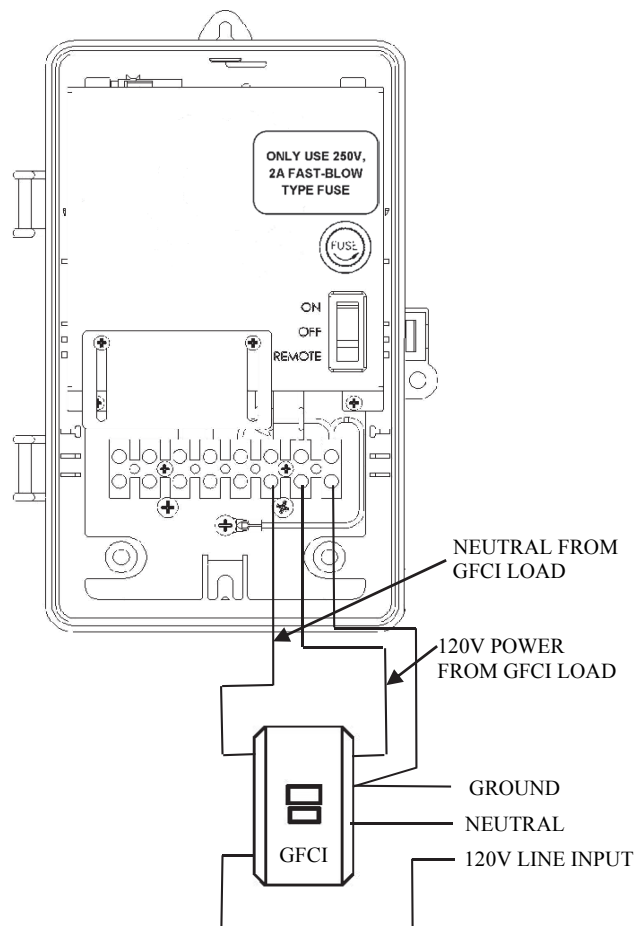

Hooking up 12VAC Light to Circuit 1

To connect a 12VAC light to the Circuit 1 switch, pull wires from the low voltage lighting product to the WIR-TRAN through conduits connected to the left bottom of the WIR-TRAN. Some lights may identify a 12VAC Hot and Neutral lead though this is not typical with 12VAC low voltage lighting. If it does identify specific leads, then follow the below instructions.

As illustrated, connect the light that will be operated by the Rocker Switch to the Light Hot terminal. Connect the Light Neutral to the Light Neutral terminal. Do not exceed demand of 30 watts @ 12V.

Two UL listed wire nuts have been included to simplify connection of up to five lights to the terminal strip. If conductors are stranded 18AWG wire or smaller, use a crimping tool and the supplied copper wire ferrules for a secure installation.

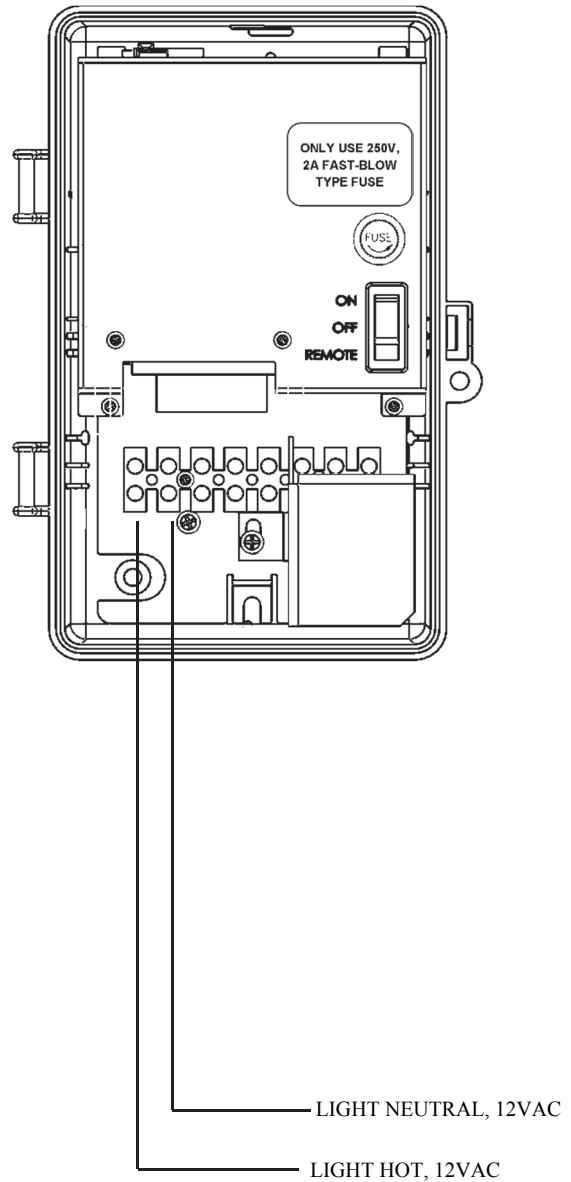

Repeater Mounting

The WIR-TRAN is equipped with a signal repeater that can be mounted up to 10 feet from the WIR-TRAN unit. This repeater receives signals from the wireless remote and sends that signal to the WIR-TRAN via the 10 foot cable. Establish a location for the Repeater that is in line of sight from where the wireless remote will be used most frequently, and is no more than 75 feet from where the remote will be used. NOTE: If extension is needed, use S.R. Smith part number WE-65 and follow installation instructions supplied with the Repeater Extension.

To mount the Repeater, carefully insert a small flathead screwdriver into groove between the Dome and Base approximately where the locking dimples are located. Pry the Dome out of the locking dimples. Next, carefully insert the small flathead screwdriver into the groove between the Dome and the Base in an adjacent locking dimple and pry the Dome out. Separate the Dome from the Base by hand. Using the supplied self-drilling screws, locate a suitable mounting surface and screw the base to this surface. (The Repeater must be mounted in plain sight not more than 75 feet from the point where the remote will be used.) Note that the marking “TOP” must be in the 12 o’clock position and the wire slit must be in the 6 o’clock position. Do not over tighten the screws as it may damage the Repeater base. Realign the Repeater Dome to the Base and ensure that the wire is exiting the base through the slit and the Locking Dimples are aligned with the locking holes. Apply enough pressure so that the Dome “snaps” into the base.

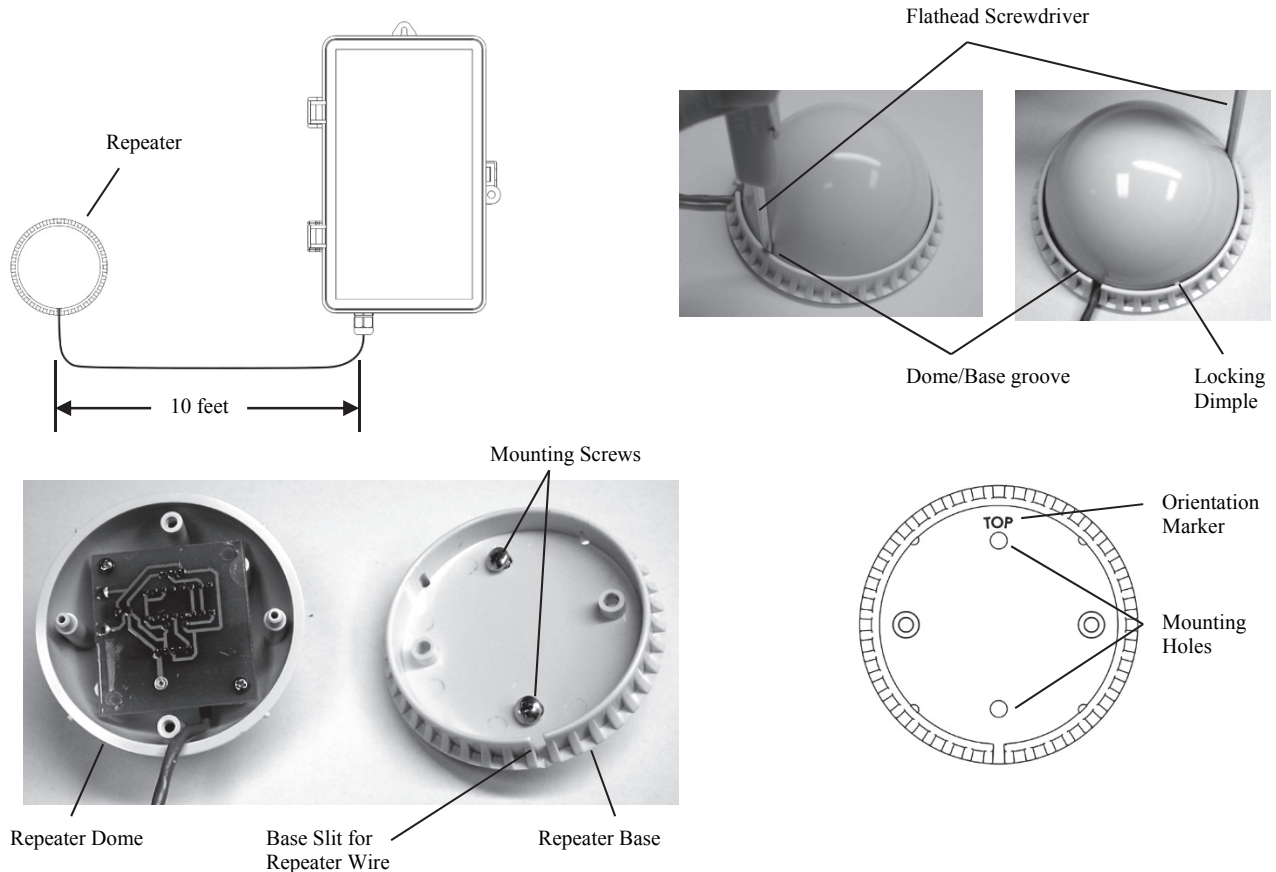

OPERATING INSTRUCTIONS

WIR-TRAN ROCKER SWITCH OPERATION

The WIR-TRAN receiver box houses one rocker switch for operation with the wireless transmitter. The switch must be in the DOWN position before powering on for the first time. To manually turn ON the 12VAC light connected to the Rocker Switch, flip the Rocker Switch UP or to the ON position. When the Rocker Switch is in the ON position, the Wireless Remote will not be able to turn OFF the 12VAC light connected to the Rocker Switch terminal. To turn OFF the 12VAC light manually, flip the Rocker Switch to the MIDDLE or OFF position. NOTE: In the OFF position, the wireless remote operation will be bypassed. To re-enable the wireless remote operation, flip the Rocker Switch back to the BOTTOM or REMOTE position.

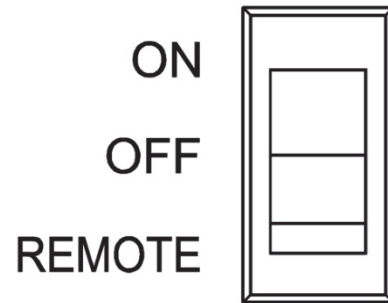

NOTE: Switch is shown in the ON position.

WIRELESS REMOTE OPERATION

NOTE: The Rocker Switch on the WIR-TRAN must be set to REMOTE for wireless operation. The POWER ON/OFF button controls the 12VAC light connected to the Rocker Switch terminal. With each push of the button, the WIR-TRAN toggles the light ON and OFF.

