

OPAL XL

Cartridge Filter

For crystal clear, sparkling water

Opal XL cartridge filters are designed to house an extra large filter cartridge, maximising its dirt holding capacity and minimising filter maintenance.

The filter's dome lid is equipped with grip handles that allows easy access to the filter cartridge for removal, cleaning and installation in a matter of minutes.

The Opal XL cartridge filters are ideal for applications where back washing may not be practical or areas where water may be scarce.



Rugged Construction

Constructed from high impact polypropylene and designed for easy maintenance. The Opal XL cartridge filters will provide years of trouble free service.



Easy to read pressure gauge.

Air relief valve.

Dome shaped lid is equipped with grip handles that allowing simple cartridge removal and replacement.

Solid one piece moulded polymer tank. Low profile for easy cartridge removal and inconspicuous enclosure.

Tough heavy duty polyester filter fabric with wide and deep pleats for better filter efficiency, easy cleaning and longer cartridge life.

2" quick connect barrel unions for UPVC pipe.

Extra Large Filter Cartridge

Opal XL filter cartridges are fabricated from pleated reusable polyester fabric. The extra larger size cartridge has been pleated to provide 225ft² to 270ft² of surface area maximising its dirt holding capacity and minimising filter maintenance.

Material: Polyester fabric material, plastisol end caps and a polypropylene core.

Operating Temperature: 39F to 122F

Maximum Pressure Drop: 50 PSI



Simple Maintenance

The filter cartridge is easily cleaned by hosing the pleats with a standard garden hose.

Dimensions

Technical Specifications

Model	Filter Area	Vertical Clearance	Filter Diameter	Flow Rate
	Sq. Ft.	Inch	Inch	GPM
Opal XL 225	225	48"	10.2"	85
Opal XL 270	270	54"	10.2"	134

Model	Turnover Capacity (Gallons)		
	8 hours	10 hours	12 hours
Opal XL 225	40800	51000	61200
Opal XL 270	40800	60000	72000

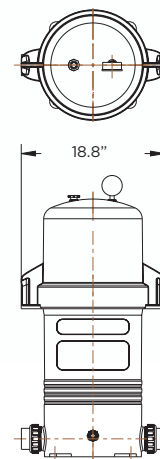

Opal XL 270

Opal XL 225

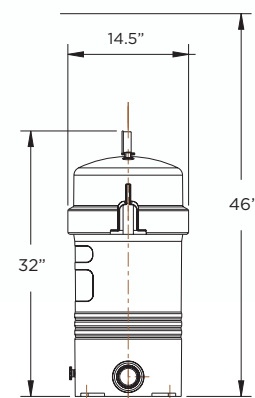
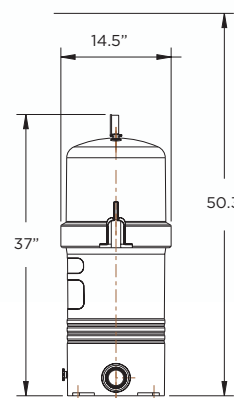

OFFICES - North America

Waterco (USA) Inc
Augusta, Georgia, USA
Tel: +1 706 793 7291
Waterco Canada
Longueuil, Quebec, Canada
Tel: +1 450 748 1421

OFFICES - OVERSEAS

NSW - Sydney (Head Office)
Tel: +61 2 9898 8600
Waterco (Europe) Limited
Sittingbourne, Kent, UK
Tel: +44 (0) 1795 521 733
Waterco (NZ) Limited
Auckland, New Zealand
Tel: +64 9 525 7570
Waterco (C) Limited
Guangzhou, China
Tel: +86 20 3222 2180

Waterco (Far East) Sdn Bhd
Selangor, Malaysia
Tel: +60 3 6145 6000
PT Waterco Indonesia
Jakarta, Indonesia
Tel: +62 21 4585 1481
Waterco Singapore Intl Pte
Ltd
Nehsons Building, Singapore
Tel: +65 6344 2378

DISTRIBUTED BY:

WATERCO
water, the liquid of life



ZZB1944 10/18

In the interest of providing better quality and value we are constantly improving and updating our products. Consequently, pictures and information on our brochures may sometimes vary slightly from models available.