

32" Channel Drain Flat Grate Anti-Entrapment Suction Outlet Cover and Three-Port Manufactured Sump

VGB Series

The AquaStar line of suction outlet covers, compliant with the new Virginia Graeme-Baker Pool and Spa Safety Act (ANSI/APSP 16-2011 and NSF 50-2008)

Features

For single or multiple drain use (see installation instructions for plumbing, hydrostatic valve/drain pipe and single or multi-pump connections)

Single

Floor: 316 GPM at 3.9 fps

Wall: 208 GPM at 2.6 fps

Floor/wall: 122 GPM at 1.5 fps

25.9 square inch opening

#316 stainless steel screws

Manufactured from superior UV-resistant engineered polymers

Three ports: bottom 2½" OD, 2" ID S/S; inside 2" threaded FPT; two 2" threaded plugs included

All components meet or exceed ANSI/APSP 16-2011 and NSF 50-2008 national standards and ASTM G154 UV testing exposure

Orange disposable plastic pre-gunite/plaster insert keeps debris out and retains sump shape during construction

Must use transitional glue when attaching to PVC pipe

Now available with PVC sump – see next page for details

4 per case





The Unblockable!



With sump (concrete pools)
Part # 32CDFLxxx

Two drains in one!

STANDARD COLORS

	101		105
	102		108
	103		

Also available as sump only
p/n 32CDSBxxx 4 per case

VGB 2008 Compliant

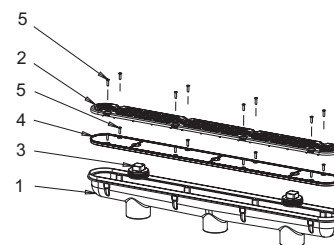
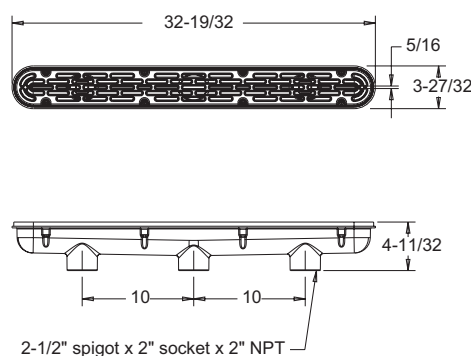

1. 32" three-port manufactured sump bucket
2. 32" channel drain, cover, flat
3. 2" NPT plug, qty 2
4. 32" channel drain, plaster shield
5. #10 x 3/4" flat head phillips type-a screw, 316 ss, qty 16

ADDITIONAL PRODUCT CONFIGURATIONS FOR 32CDPxxx (sold separately)

STANDARD COLORS



101



102



103



105



108

32" Channel Drain Flat Grate Anti-Entrapment Suction Outlet Cover and PVC Three-Port Manufactured Sump



Part #
32CDFLPxxx

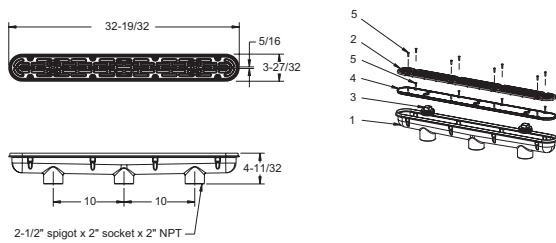

1. 32" three-port manufactured sump bucket
2. 32" channel drain, cover, flat
3. 2" NPT plug, qty 2
4. 32" channel drain, plaster shield
5. #10 x 3/4" flat head phillips type-a screw, 316 ss, qty 16

32" Channel Drain Anti-Entrapment Suction Outlet Cover and PVC Three-Port Manufactured Sump



Part #
32CDVPxxx

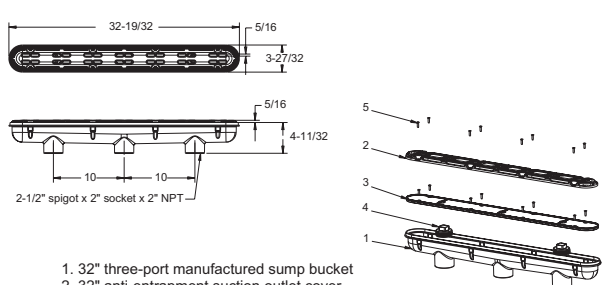

1. 32" three-port manufactured sump bucket
2. 32" anti-entrapment suction outlet cover
3. 32" channel drain, plaster shield
4. 2" NPT plug, qty 2
5. #10 x 3/4" flat head phillips type-a screw, 316 ss, qty 16

32" Channel Drain Debris Catcher Suction Outlet with PVC Three-Port Manufactured Sump

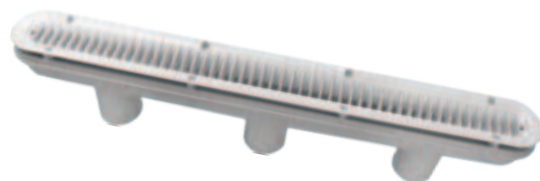

Part #
32CDLTPxxx

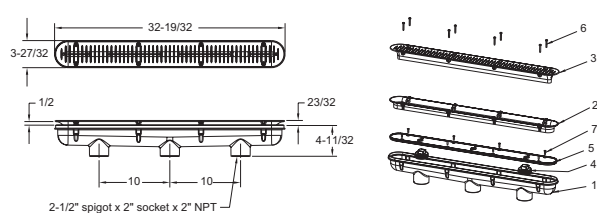

1. 32" three-port manufactured sump bucket
2. 32" leaf trap insert
3. 32" leaf trap cover
4. 2" NPT plug, qty 2
5. 32" channel drain, plaster shield
6. #10 x 3/4" pan head phillips hi-lo screw, 316 ss, qty 8
7. #10 x 3/4" flat head phillips type-a screw, 316 ss, qty 8

32" Channel Drain Pinhole Anti-Entrapment Suction Outlet Cover and PVC Three-Port Manufactured Sump

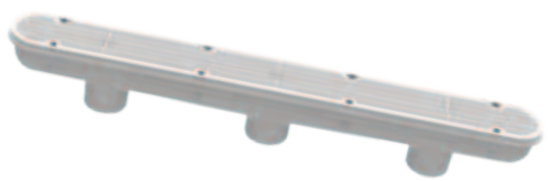

Part #
32CDPHPxxx

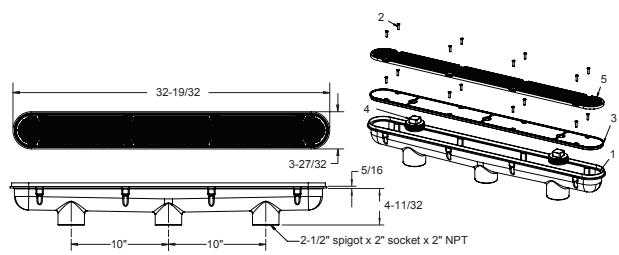

1. 32" 3 port manufactured sump
2. #10 x 3/4" flat head phillips type-a screw, 316 ss, qty 16
3. 32" channel drain, plaster shield
4. 2" NPT plug, qty 2
5. 32" channel drain anti-entrapment suction outlet "pinhole" cover